



## PLDL-SERIES PLATE AND SLAB DOLLIES INSTRUCTION MANUAL



PLDL-LD (LIGHT DUTY)



PLDL-HD (HEAVY DUTY MODELS;  
SHOWN WITH PNEUMATIC WHEELS)

### VESTIL MANUFACTURING CORP.

2999 NORTH WAYNE STREET  
 P.O. BOX 507, ANGOLA, IN 46703  
 TELEPHONE: (260) 665-7586 -OR- TOLL FREE (800) 348-0868  
 FAX: (260) 665-1339

URL: [WWW.VESTILMFG.COM](http://WWW.VESTILMFG.COM)

EMAIL: [SALES@VESTIL.COM](mailto:SALES@VESTIL.COM)

**NOTE:** Compliance with regulations, codes, and/or statutory (non-voluntary) standards enforced in the location where the dolly is *used* is exclusively the responsibility of the end-user.

#### Table of Contents

Product Introduction.....	2
Safety Principles.....	2
Use Instructions.....	4
Inspections & Maintenance.....	4

#### Table of Figures

FIG 1A: Exploded Parts Diagram and Parts List for Heavy-Duty Models.....	3
FIG 1B: Exploded Parts Diagram and Parts List for Light-Duty Model.....	3

## PRODUCT INTRODUCTION



Thank you for purchasing a PLDL-series "Plate and slab material dolly" made by Vestil Manufacturing Corporation. Vestil manufactures several distinct models, and each dolly conforms to the generalized specifications disclosed in this manual. Our dollies are durable, high-quality products rigorously engineered for dependability and simplicity.

Although use and maintenance procedures are intuitively obvious, any person who might use or maintain this product must be familiar with the instructions provided in this manual.

Dimensions and other product specifications appear in the following table:

**NOTE:** "LD" denotes a light-duty model; "HD" is used to identify heavy-duty model(s)

Model	Maximum Rated Load in Pounds (~kg)	Wheel Diameter in Inches (~cm)	Wheel Type	Dimensions in Inches (~cm)	Net weight in pounds (~kg)
PLDL-LD-2-4PP	350 (~159kg)	4 (~10cm)	Polyurethane-on-polyurethane	9½ x 7 x 10 ~(24 x 18 x 25)	9 (~4kg)
PLDL-HD-4-8MR	1200 (~545kg)	8 (~20cm)	Rubber-on-steel	13¼ x 11 x 12 ~(34 x 28 x 30)	32 (~15kg)
PLDL-HD-4-8PS	1500 (~682kg)	8 (~20cm)	Polyurethane-on-steel	13¼ x 11 x 12 ~(34 x 28 x 30)	32 (~15kg)
PLDL-HD-4-8GFN	1500 (~682kg)	8 (~20cm)	Plastic	13¼ x 11 x 12 ~(34 x 28 x 30)	30 (~14kg)
PLDL-HD-4-10PN	750 (~341kg)	10 (~25cm)	Pneumatic	14¼ x 13 x 12 ~(36 x 33 x 30)	26 (~12kg)
PLDL-HD-4-10FF	500 (~227kg)	10 (~25cm)	Foam-filled	14¼ x 13 x 12 ~(36 x 33 x 30)	26 (~12kg)

Vestil Manufacturing Corp. created this manual to acquaint owners and end-users of our dollies with recommended use and maintenance procedures. **Users should have access to the manual at all times** and should review the directions when necessary. Although Vestil diligently strives to identify foreseeable, hazardous situations, this manual cannot address every conceivable danger. The end-user is ultimately responsible for exercising sound judgment at all times.

### SAFETY PRINCIPLES

Vestil Manufacturing Corp. recognizes the critical importance of workplace safety. Each person who **might** participate in the assembly, installation, use or maintenance of the product must read this manual **and fully understand the directions BEFORE using the product and before performing maintenance on it. Failure to adhere to the instructions in this manual might lead to serious personal injury.**

Vestil is **not liable** for any injury or property damage that occurs as a consequence of failing to heed the instructions in this manual. Furthermore, failure to exercise good judgment and common sense may result in either property damage or serious personal injury or both. Such failure is solely the fault of the person(s) who acted without good judgment; it is **not yet another liability of the manufacturer.**

This manual uses SIGNAL WORDS to classify personal injury risks or situations that might lead to property damage, as well as to draw attention to safety message(s). The reader must understand that each signal word indicates a specific level of seriousness about the hazard described.

**▲ DANGER** Identifies a hazardous situation which, if not avoided, **WILL** result in DEATH or SERIOUS INJURY. Use of this signal word is limited to the most extreme situations.

**▲ WARNING** Identifies a hazardous situation which, if not avoided, **COULD** result in DEATH or SERIOUS INJURY.

**▲ CAUTION** Indicates a hazardous situation which, if not avoided, **COULD** result in MINOR or MODERATE injury.

**NOTICE** Identifies practices likely to result in product/property damage, such as use(s) that might damage the cargo restraining beam.

Each person who uses the dolly should study the entire manual before using the product for the first time. **Failure to read and understand the instructions included in this manual before using or performing maintenance on the dolly constitutes misuse of the product.** When necessary, read the manual again to refresh your understanding of the use / maintenance procedures explained on p. 4. DO NOT attempt to resolve any problems with the product unless you are authorized to do so and are certain that it will be safe to use afterwards.

**FIG 1A: EXPLODED PARTS DIAGRAM AND PARTS LIST FOR HEAVY-DUTY MODELS (PLDL-HD-4-\_\_\_)**

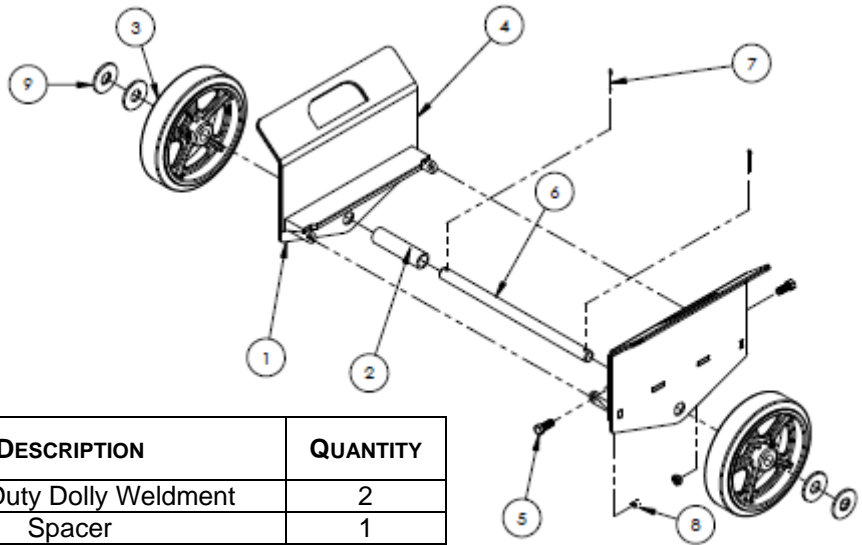

ITEM NUMBER	PART NUMBER	DESCRIPTION	QUANTITY
1	16-514-143	Heavy Duty Dolly Weldment	2
2	16-113-019	Spacer	1
3	<u>Wheel packages</u> 16-132-239 16-132-039-001 16-132-208-001 16-132-198-002  16-132-240	<u>Wheel packages</u> 8in. rubber-on steel wheel; 8in. polyurethane-on-steel wheel; 8in. glass filled nylon wheel; 10in. x 3.5in. pneumatic wheel for 3/4 in. axle; -OR- 10in. foam filled wheel	2 2 2 2  2
4	16-001-202-A	Heavy-Duty Spray-on Liner	2
5	11105	3/8 in. -16 x 1in. #2 z-plated bolt	2
6	16-112-025	Long axle	1
7	65077	1/8 in. x 1 1/4 in. z-plated cotter pin	2
8	37026	3/8in.-16 z-plated nylock nut	2
9	33018	3/4 in. z-plated flat washer	4

**FIG 1B: EXPLODED PARTS DIAGRAM & PARTS LIST FOR LIGHT-DUTY MODEL (PLDL-LD-2-4PP)**

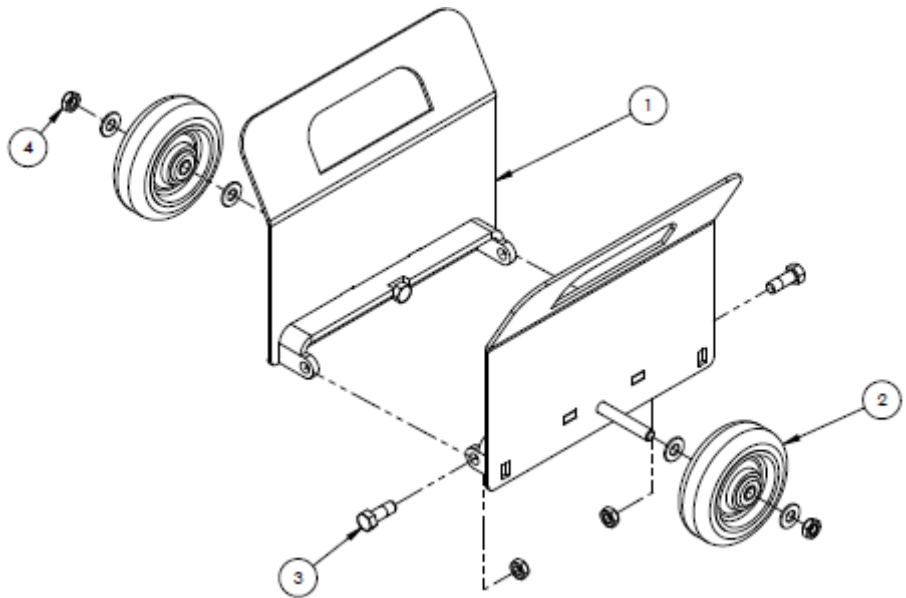

ITEM NUMBER	PART NUMBER	DESCRIPTION	QUANTITY
1	16-514-144	Light-duty frame weldment	2
2	16-132-009	HR - 4 / 1.25 - SLB- S	2
3	11105	3/8 in. -16 x 1in. #2 z-plated bolt	2
4	37026	3/8in.-16 z-plated nylock nut	4

**⚠WARNING**

Improper or careless use might result in serious personal injuries! To reduce the likelihood of incidents that result in injury:

- Inspect the dolly before each use according to the “Inspections & Maintenance” instructions below. Immediately remove the dolly from service and/or replace it if a problem(s) is found during any inspection.
- DO NOT modify the dolly in any way UNLESS you first obtain express, written approval from Vestil. Unauthorized modifications might make the product unsafe to use, and could result in personal injury.
- DO NOT attempt to move a load/material with the dolly if you cannot *easily* control the load. Use a different material handling method to transport the load/material.
- DO NOT walk beside the load while transporting it with the dolly. If you lose control of the load, it might fall on top of you. Always position yourself entirely behind the load and push the load to the desired location.

**Use Instructions**

**Step 1:** Determine the proper location for the dolly. Orient the load / material with the longest dimension parallel to the ground. Position the center line of the dolly in line with the vertical center line of the load/material as shown in the diagram to the right. If the dolly is not properly centered, the slab material will not be level. Push the load from one end, and make sure that your body remains completely behind the load while moving it with the dolly. Do not lift the load while pushing it; try to simply push the load in a direction parallel to the floor.

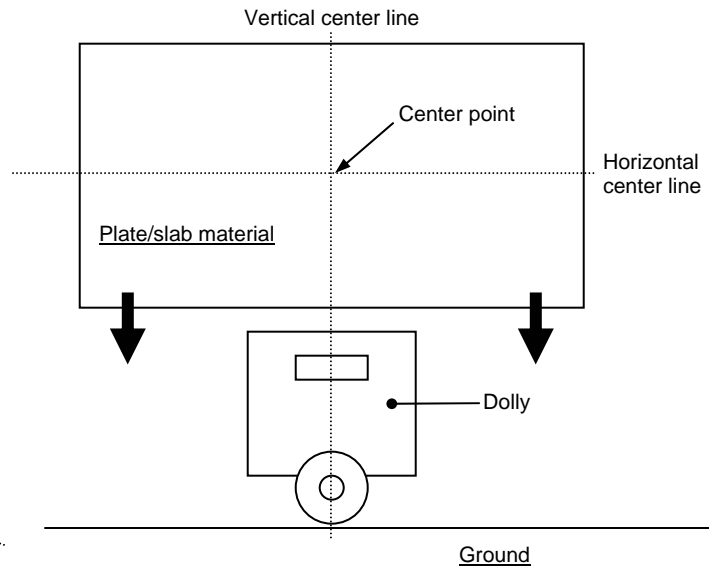
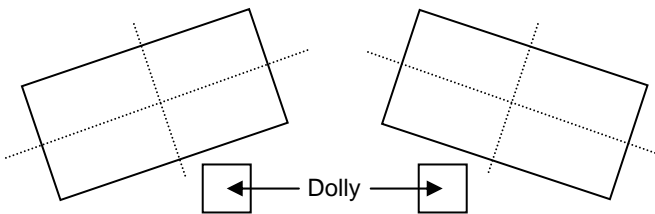
Improperly centered dolly

**Step 2:** If you cannot easily control the slab material by yourself, ask someone to assist you. The helper should stabilize and guide the load from the front, while you also stabilize the load and push it from the rear. If the load still cannot be easily controlled, do not use the dolly to transport the material.

**Step 3:** If the length of the slab material requires 2 dollies to adequately stabilize the load, position the dollies equal distances from (on either side of) the vertical centerline (see diagram to the right). A second person should help you move the material according to the instructions in step 2.

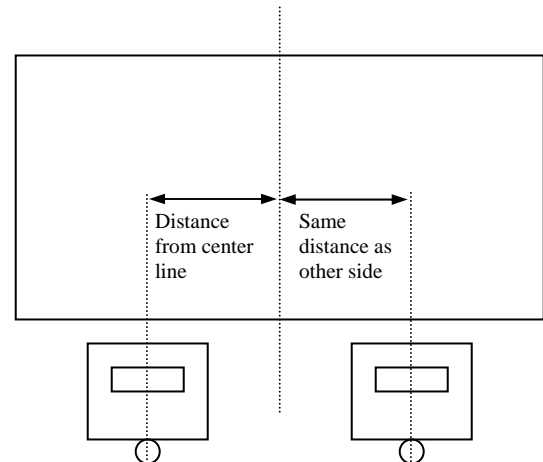
**Inspections & Maintenance**

Before each use:

- Inspect the wheels/casters for embedded material and remove it. Also look for cracks or deformities. If the dolly cannot roll smoothly across the floor due to wheel/caster damage, remove the dolly from service. Do not use the dolly again until approved replacement parts have been installed.
- Closely inspect the dolly for loose and/or missing parts (see FIG's 1A and 1B on p. 3). Install replacement parts as required before using the dolly.
- Also inspect the axle and axle bearing for damage (cracks, deformation, break(s)). Remove the dolly from service if either the axle or the axle bearing is damaged. Replace the damaged component before using the dolly again.
- Open the dolly and examine the hinge; then turn the dolly over and examine the bottom side of the hinge. If the hinge is pulling apart, remove the dolly from service.
- Wipe dirt and other filth from the inner and outer surfaces of the dolly.